



## 9W PIR LED Light Bulb B22 E27 Motion Sensor Light Bulb Energy Efficient

### Our Product Introduction

for more products please visit us on [led-lightsbulb.com](http://led-lightsbulb.com)

#### Basic Information

- Place of Origin: Shenzhen. China
- Brand Name: NCJ TECH
- Certification: CE
- Model Number: NSL-AL02
- Minimum Order Quantity: 100 pcs
- Price: Negotiation
- Packaging Details: White box + Outer box (K=A)
- Delivery Time: 1: Sample and small order: Within 7 working days after receiving your payment. 2: Bulk order: 3-4 weeks after receiving your deposit.
- Payment Terms: T/T, Paypal
- Supply Ability: 10000pcs per month



#### Product Specification

- Voltage: AC85-265V
- Material: Aluminum+PC Housing
- Wattage: 5W/7W/9W
- Color Temperature: 3000k-6500k
- Luminous Lux: 90lm/w
- Light Base: E27 B22
- Beam Angle: 120°
- Highlight: 9W PIR LED Light Bulb, PIR LED Light Bulb B22, E27 Motion Sensor Light Bulb



#### More Images





Product Description

E27 B22 PIR Sensor Lights Voltage AC85-265V Wattage 5W/7W/9W Base

Product Description:

PIR Sensor Lights are the perfect choice for any home or office that needs to reduce energy costs and increase safety and security. These lights are motion-activated, so they will turn on when motion is detected, and turn off when there is no motion. This is both cost-effective and energy-efficient, saving you money on your electricity bills. The infrared detecting lights are made from aluminum and PC housing, and come in three different wattages - 5W, 7W and 9W. The light base is E27 or B22, and the color temperature ranges from 3000K to 6500K. Best of all, the luminous lux is 90ml/w, so you can be sure that you will get the perfect amount of illumination for any space. With these motion-detection lights, you can rest assured that your home or office will be well-lit and secure.

Technical Parameters:

Parameter	Specification
Product Name	PIR Sensor Lights
Key Feature	Infrared Detecting Lights, Motion-Activated Lights, Infrared Detecting Lights
Wattage	5W/7W/9W
Material	Aluminum+PC Housing
Voltage	AC85-265V
Luminous Lux	90ml/w
Light Base	E27 B22
Color Temperature	3000k-6500k
Beam Angle	120°

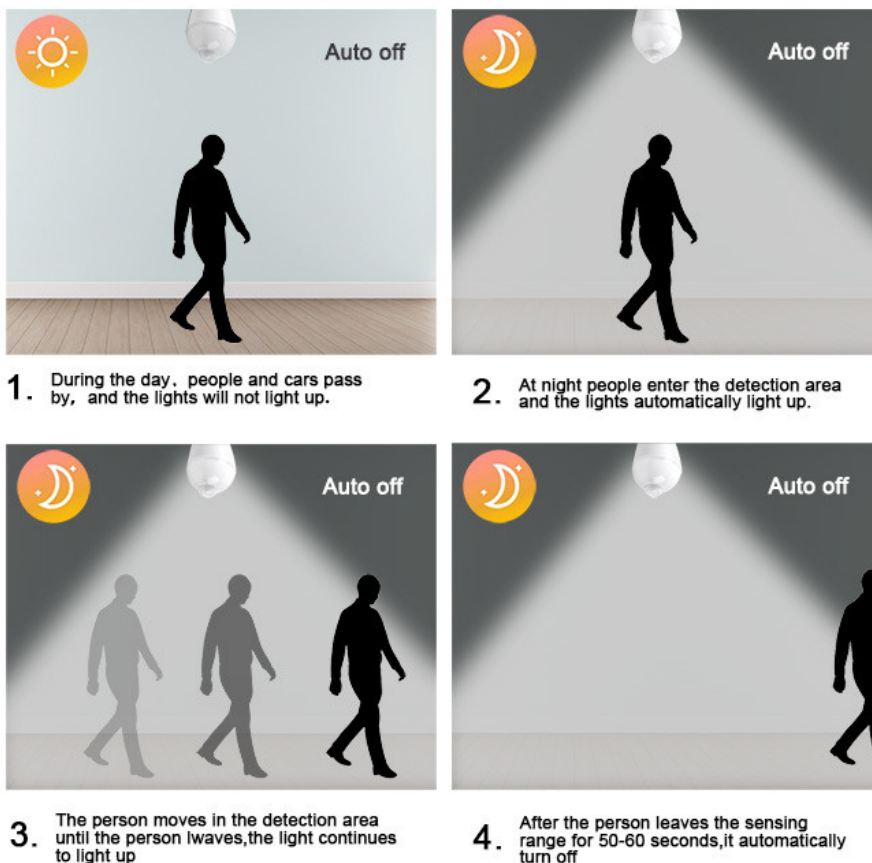

## Support and Services:

### PIR Sensor Lights Technical Support and Services

We offer our customers technical support and services for PIR Sensor Lights. We provide a wide range of services to help customers get the most out of their product. Our services include:

Installation - we provide installation services for PIR Sensor Lights.

Troubleshooting - we provide troubleshooting services for any issues you may have with PIR Sensor Lights.

Replacement Parts - we provide replacement parts for PIR Sensor Lights.

Warranty - we provide a warranty for PIR Sensor Lights.

Technical Assistance - we provide technical assistance for PIR Sensor Lights.

## Packing and Shipping:

### Packaging and Shipping for PIR Sensor Lights

The PIR Sensor Lights will be packaged and shipped in the following way:

The product will be securely packaged in a box with foam padding to ensure it remains safe during transportation.

The product will be shipped via a reliable courier service.

Once shipped, tracking information will be provided to the customer.



**Shenzhen NCJ Technology Co., Ltd.**



+86 13652683981



ivy@ncj-tech.com



led-lightbulb.com

201,19 Building, Heshuikou NO.2 Industrial Zone, Matian Street, Guangming District, Shenzhen City, China